

# EVF LIGHTING FIXTURES

series/serisi

Aydınlatma Armatürleri

## INSTALLATION / KULLANIM

Hazardous Areas, Zone: 1/2 (Gases) - 21/22 (Dusts)  
Tehlikeli Sahalar, Bölge: 1/2 (Gazlar) - 21/22 (Toz)

## CLASSIFICATION/ SINIFLANDIRMA

Group II - Category 2G/2D  
Grup II - Kategori 2G/2D



## EVF.EM

With Emergency Kit

Acil Aydınlatma Kitli



### UYGULAMA

EVF.EM serisi floresan aydınlatma armatürleri bir ve ya üç saatlik acil aydınlatma kiti ile birlikte Grup II tehlikeli açık ya da kapalı alanlarda kullanılmaktadır.

### APPLICATION

EVF.EM series fluorescent lighting fixtures are used in Group II hazardous areas with one or three hours Emergency Kit at indoor or outdoor services.

## EVF Series Lighting Fixtures

### ATEX 94/9/EC

<b>Execution/Sertifika Kodu</b>	II 2 G Ex ed IIB Gb II 2 D Ex IIIC IP 66 Db
<b>Installation/Kullanım Sahası</b>	Zone 1/2 - Zone 21/22
<b>Protection Degree/Koruma Sınıfı</b>	IP 66
<b>Certificate Ref./Sertifika No</b>	MP 11 ATEX 0084
<b>Rules of compl./ Uyum Kuralları</b>	EN 60079-0:2012; EN 60079-7:2007; EN 60079-31:2009



DÜNYAEKS ELEKTRİK MAKİNA  
MÜH. SAN. VE TİC. LTD. ŞTİ.

Exproof Equipment



## Assembly

Figure 1

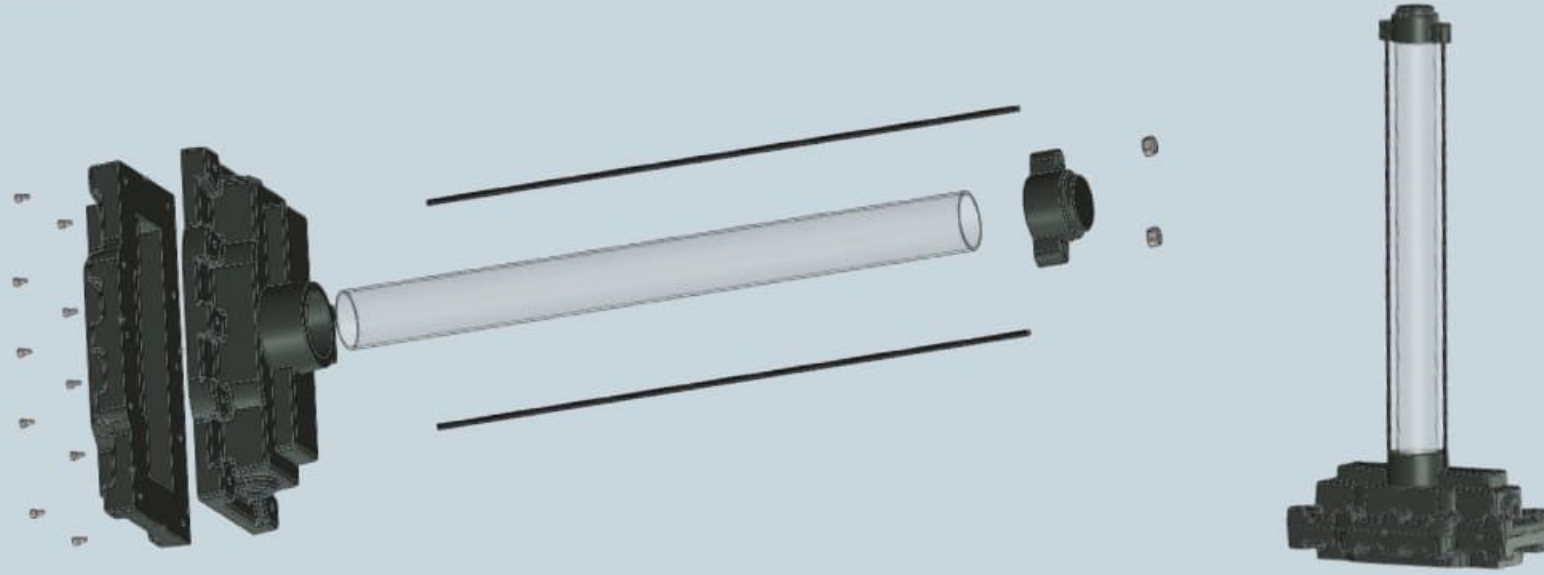

Mechanical Characteristics		Electrical Characteristics	
<b>Body/Gövde</b>	Aluminium/Alüminyum	<b>Internal Wiring/Kablolar</b>	High Temperature Resistant Silicon Cable/ Silikon Kablo
<b>Painting/Boya</b>	Epoxy powder/Elektrostatik Boya	<b>Power Supply/ Güç Kaynağı</b>	Electronic Ballast/Elektronik Balast
<b>Cable Entry/ Kablo Girişi</b>	2x1/2"	<b>Screws/Civata</b>	Stainless Steel / Paslanmaz Çelik

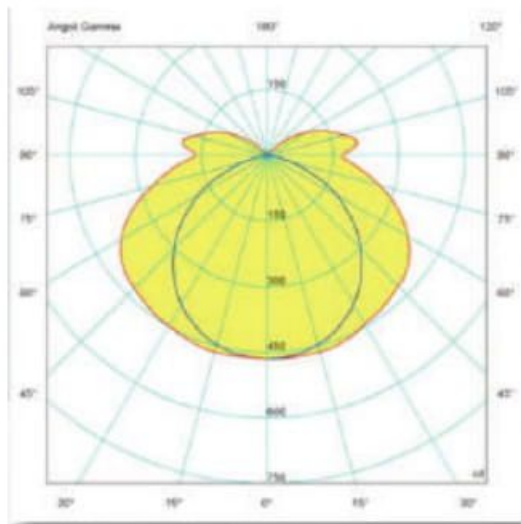

EVF.2x18

Photometric diagrams

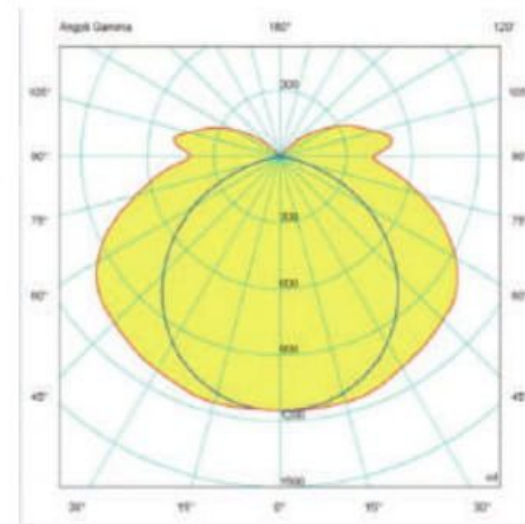

EVF.2x36

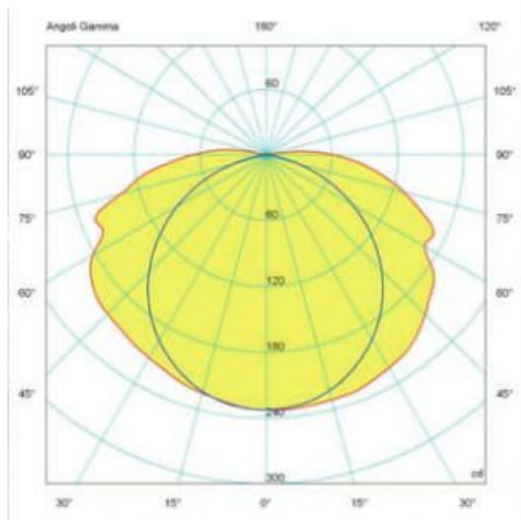

EVF.1x18

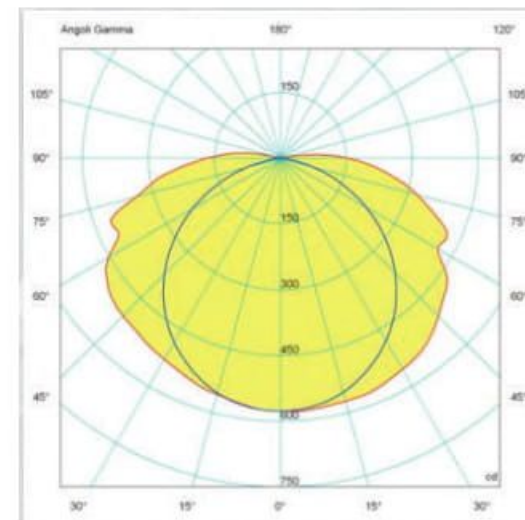

EVF.1x36



## TECHNICAL DATA

Kod CODE	Lamba LAMP	Gazlar için sıcaklık TEMP. CLASS (GAS)	Tozlar için sıcaklık TEMP. CLASS (DUST)	Florasan Duy Tipi LAMP HOLDER	Kablo Girişi CABLE ENTRY SIZE
<b>TECHNICAL DATA</b>					
EVE.1x36	36 W	T5 T4	T 100 °C T 180 °C	T8	2X1/2"
EVE.1x18	18 W	T5 T4	T 100 °C T 180 °C	T8	2X1/2"
EVE.2x36	2x36 W	T5 T4	T 100 °C T 180 °C	T8	2X1/2"
EVE.2x18	2x18 W	T5 T4	T 100 °C T 180 °C	T8	2X1/2"

### Assembly

Figure 3

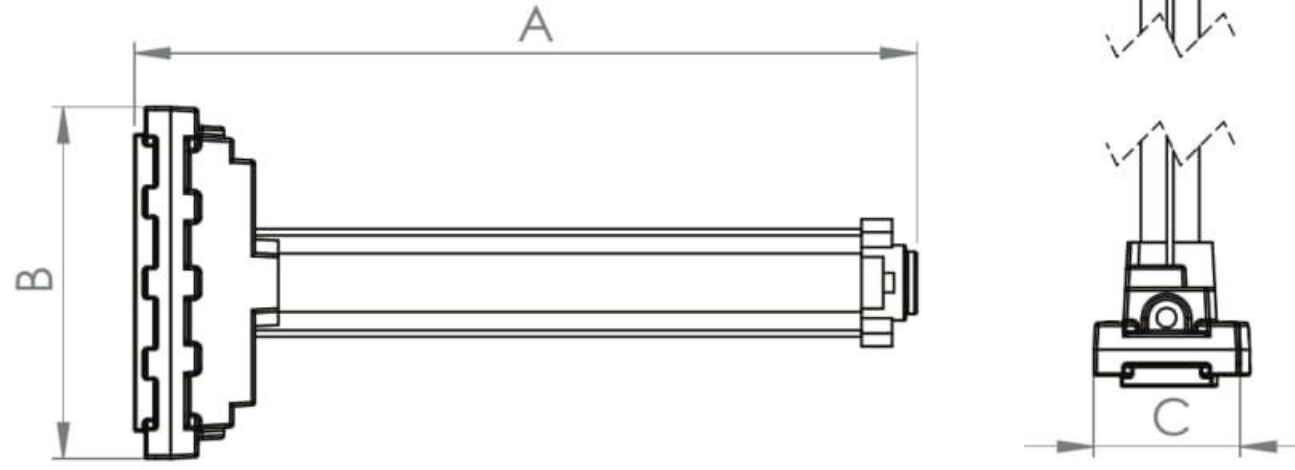

CODE/Kodu	A	B	C	WEIGHT/Ağırlık (K.G)	DETAIL/Detay
EVE.1X36	1300 mm	325 mm	130 mm	7.5 KG	Figure 3
EVE.1X18	700 mm	325 mm	130 mm	8 KG	Figure 3
EVE.2X36	1300 mm	325 mm	130 mm	16.50 Kg	Figure 2
EVE.2X18	700 mm	325 mm	130 mm	10 Kg	Figure 2